



Type B96DKT-...

The palm grip B 9 is an actuating element for our multi-axis controller V 8, VV 8, V 6, VV 6, VV 5. It can also be used as an actuating element for hydraulic drives. Push buttons, rocker switches, e.t.c., can also be fitted to suit appropriate requirements. The drives with potentiometer PA 11 and PA 13 realised the direction 11-12 resp. 13-14 (3. resp. 4 axis) on our multi-axis controllers.

The palm grip has a highly flexible single wire 0,1 mm² x 450 mm long.

The mounting piece for the drive rod can be supplied with a tapped hole 12 or 10 mm (standard = 12 mm).

The palm grip B 9 is made of PA plastic and is grey in colour.

Contact complement 0,5 A 110 V AC 15 or 1,5 A 24 V DC 13
I min > 0,2 mA 2 V DC 12 Gold plated for max. load of 0,12 Watt (standard)

Micro change over contacts available on request

Permissible ambient temperature	Operating	-40°C to +60°C
	Storage	-50°C to +80°C

Climate resistance	IEC 60068-2-78
Damp heat constant	IEC 60068-2-30
Damp heat cyclic	IEC 60068-2-30
Degree of protection front	IP 65 IEC/ IEN 60529

Pos.		Contact-complement	Weight gramm	Type	Price EURO
1	Palm grip with mounting piece for control-handle		230	B 9	
2	Push button installed Pos. 1, 2, 3, 4, 5, 6 color red RD, black BK, yellow YE, green GN, blue BU, white WH	1 normally open	20	D	
3	Cross switch tip-0-tip T-0-T / T-0-T	4 normally open	60	KT	
5	Cross switch rest-0-rest R-0-R / R-0-R	4 normally open	60	KR	
6					
10					
11	Drive with potentiometer PA 11 actuating by rocker wheel with spring return in the centre position 1 conductive-plastic potentiometer T 394 with centre tap Linear 10 ⁷ switching cycles resistance 2 x 5 kOhm 0,5 Watt wiper current max. 1 mA, 2 direction-contacts	2 normally open	90	PA 11	
13	Drive with potentiometer PA 13 actuating by rotating palm grip left resp. right with spring return in the centre position 1 conductive-plastic potentiometer T 375 with centre tap Linear 10 ⁷ switching cycles resistance 2 x 5 kOhm 0,5 Watt wiper current max. 1 mA, 2 direction-contacts	2 normally open	90	PA 13	
22	Multi-axis controller V 21 see catalog 1/146				
30	Bellow for palm grip B 9 required for multi-axis controller V 8, VV 8	KMD 109			
31	Bellow for palm grip B 9 and front plate with 4 screws M5 x 15 (for mounting the bellow) required for multi-axis controller V 6, VV 6, VV 5	KMD 190 KBF 905			
32					
33					

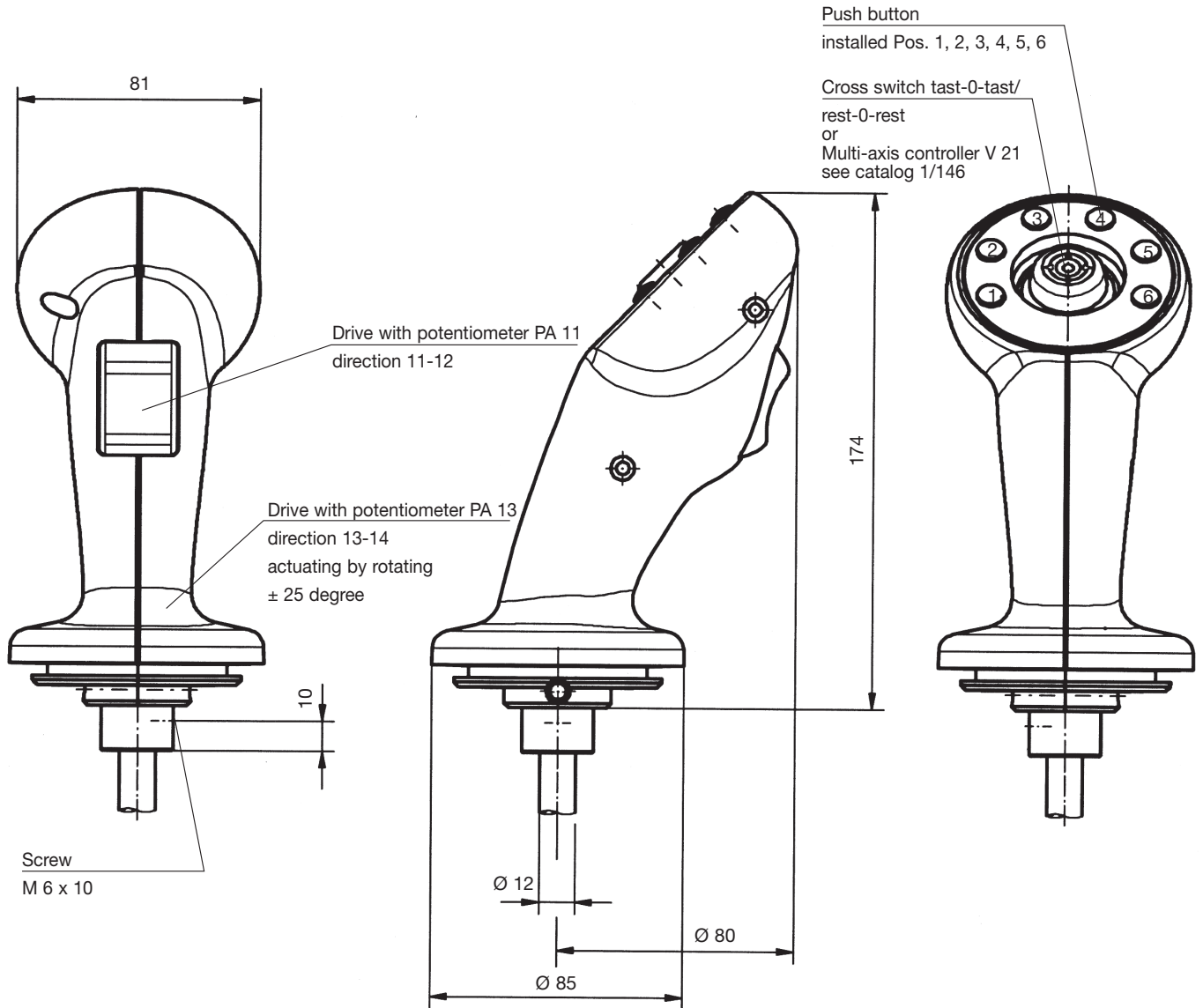

Example for type-sign

B 9 D KT PA 11 PA 13 - X

Palm grip
Push button
Cross switch



Special please describe
Drive with potentiometer PA 13
Drive with potentiometer PA 11